

Langton Road, Norton.

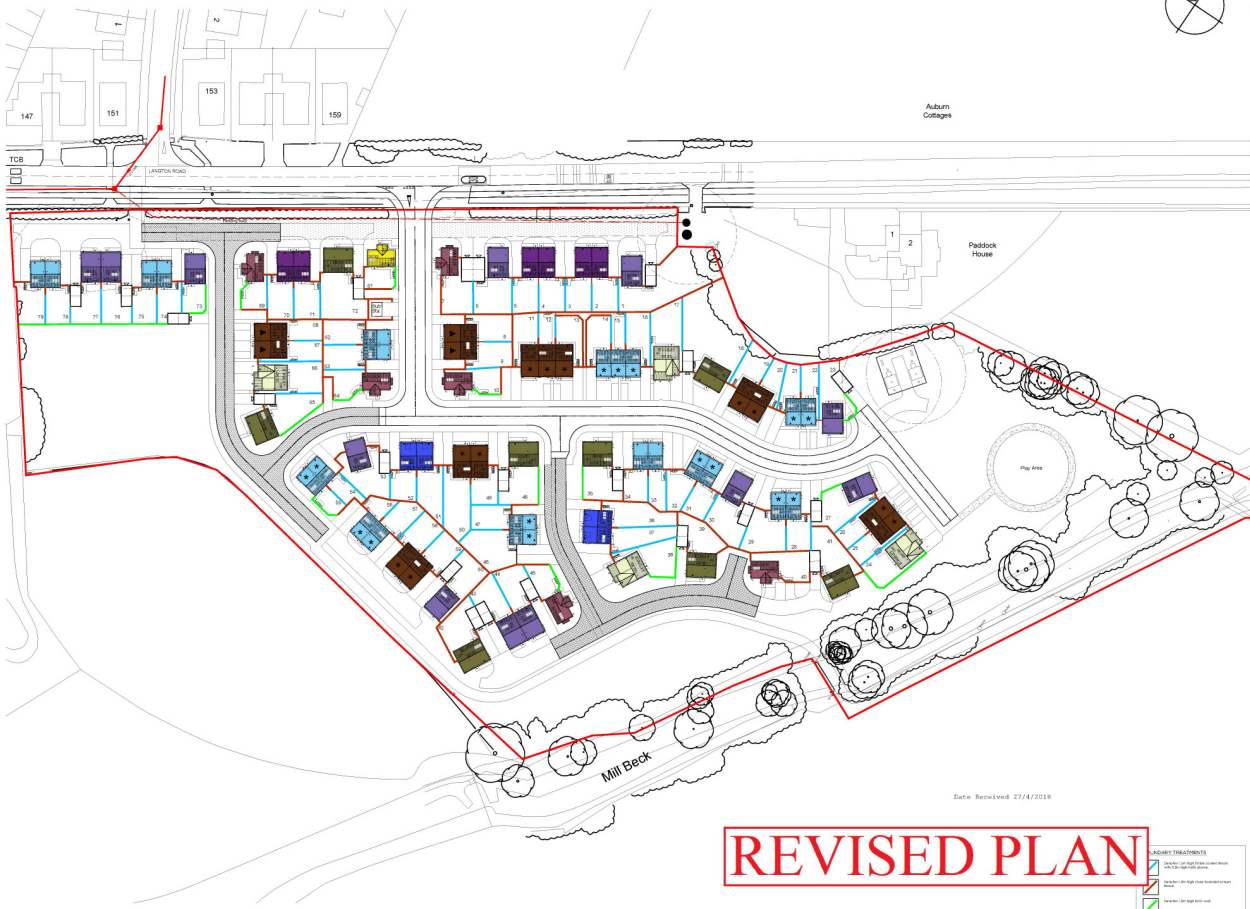

The Designer of this Boundary Treatments Plan (BTP) has designed the BTP in accordance with the requirements of any applicable legislation and standards.

- The BTP is designed to ensure that the proposed development is in accordance with the requirements of any applicable legislation and standards.
- The BTP is designed to ensure that the proposed development is in accordance with the requirements of any applicable legislation and standards.
- The BTP is designed to ensure that the proposed development is in accordance with the requirements of any applicable legislation and standards.
- The BTP is designed to ensure that the proposed development is in accordance with the requirements of any applicable legislation and standards.
- The BTP is designed to ensure that the proposed development is in accordance with the requirements of any applicable legislation and standards.
- The BTP is designed to ensure that the proposed development is in accordance with the requirements of any applicable legislation and standards.
- The BTP is designed to ensure that the proposed development is in accordance with the requirements of any applicable legislation and standards.
- The BTP is designed to ensure that the proposed development is in accordance with the requirements of any applicable legislation and standards.



Date Received 27/4/2019

REVISED PLAN

BOUNDARY TREATMENTS
 - On high level roads
 - On high level roads
 - On high level roads

100% 100% 100% 100%

Keepmoat

Proposed Residential Development,
Langton Road, Norton.

NO.	DATE	BY	FOR
1	10/02/19	MM	MM
2	14/02/19	MM	MM

MPSL